



Objectives

- To renovate and renew an existing space that does not properly provide for its users.
- To give a new look and image to the Center for Performing Arts.
- To help resolve tension among users created in the space because of its lack of functioning.

Research

- Talk with students and employees revealed a desire for the space to be utilized similarly in some ways and different in others. For people working in the library and offices they request visual/sun barriers and quiet. The students need a resting place to eat a quick lunch and rendezvous with friends as well as a quick path through the space to their classes.

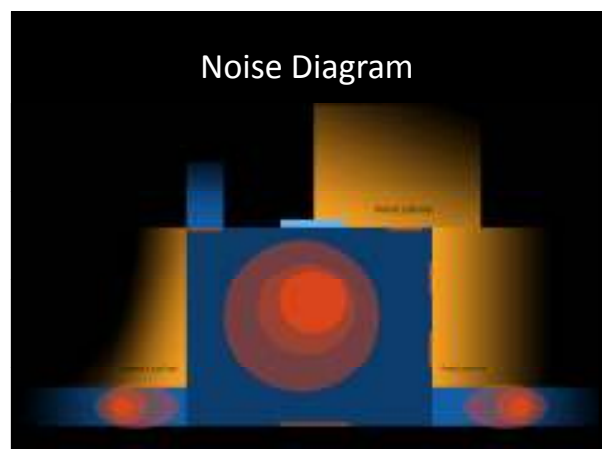
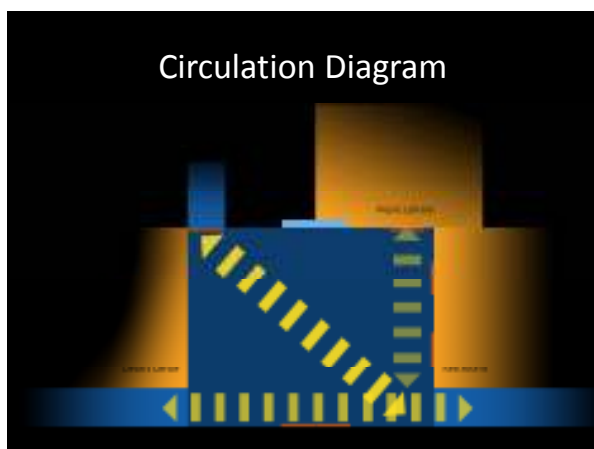

Solution

- Provide a more active and readily used lounge and break area for students while also keeping noise pollution down for library and office users.
- Create a more aesthetically pleasing entrance area by encasing trash, recycle, and book return bins and allowing students to pin up event posters in a more fashionable manner.

Solution

- Provide wool soundproofing panels on office glass dividers and in hallways that can be utilized as pin-up space.
- Provide a new lounge couch for the students as well as mobile tables and chairs to ease circulation.
- Create a display case that encloses the trash, recycling, and book return functions in its base.
- Utilize existing display case for theatre purposes and other for library purposes.

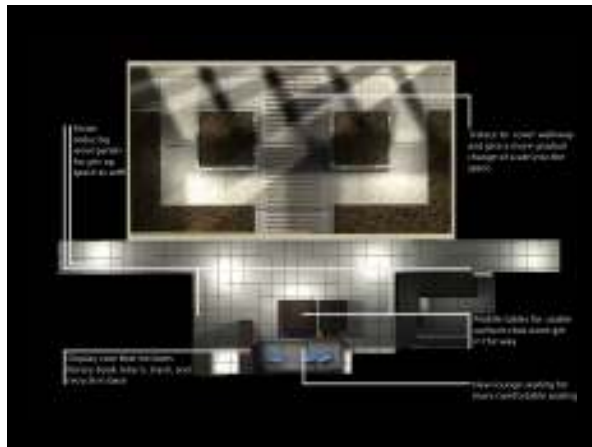

Furniture



- Movable light weight stools that can be stacked and used around mobile tables.

Furniture



- New lounge couch for student area



Wall Treatment



- Different fabric materials are being used for interior noise reduction. One of the most successful aesthetically and acoustically is wool. Gives texture to the walls and provides pin-up space.

Design Conclusion

- The design implementation for the space is meant to be minimal. The interior entrance does not offer much space for the addition of furniture, however, there is an obvious desire for some. The use of functional pieces, such as the display shelf, as well as small movable pieces allows the space to provide for multiple uses. The exterior entrance is architecturally beautiful as it exists now. The addition of a suspended covered walkway is meant to tie the exterior and interior through similar wood types and construction. The sound proofing is meant to deaden noise from the student meeting area and practice areas at the ends of the halls. Window decals are meant to block some sunlight and give identity to the building.